



## A SEAMLESS HOTEL EXPERIENCE IN DAVAO CITY'S PREMIER LIFESTYLE DESTINATION

Seda Abreeza offers quality accommodations and world-class service for discerning travellers in Davao City, southern Mindanao's hub of commerce, tourism and industry. Just 20 minutes away from Davao International Airport, the 150-room Seda Abreeza ushers guests to a world of unparalleled comfort and convenience, and is only a few steps to upscale Abreeza Mall with its numerous lifestyle options.

Seda Abreeza - weaving destination, service and value into a remarkable hospitality experience.



Learn more about Seda Abreeza by scanning the QR code above



## GUEST ROOM

### DELUXE ROOM

Equipped with modern amenities in a comfortable 28 sqm area

### CLUB ROOM

Access to the Club Lounge; daily Continental breakfast, afternoon tea and cocktails; all-day coffee, tea and non-alcoholic beverages; iMac stations; work tables; reading materials; a wide-screen LED HDTV with cable channels; secretarial assistance

### PREMIER ROOM

35 sqm with a bath tub, kitchenette, and Club Lounge access

## IN-ROOM AMENITIES

- 40-inch LED HDTV with cable TV
- Media panel with HDMI, USB and audio-visual connectivity
- IDD phone with iPod dock, alarm clock and FM radio
- Complimentary WiFi and internet access
- Mini-bar
- Coffee & tea-making facilities
- Executive desk
- Safety deposit box
- Iron and ironing board (available upon request)



## RESTAURANT & BAR

### MISTO

All-day dining restaurant with a medley of international classics and local favorites



## FACILITIES & SERVICES

- Airport and city transfers
- Club Lounge
- E-lounge
- Function rooms
- Gym
- In-room dining
- In-room massage
- Laundry and dry-cleaning
- Parking
- Swimming pools
- Complimentary WiFi

## PLACES OF INTEREST

- Davao Crocodile Park
- Philippine Eagle Centre
- Malagos Garden Resort
- Eden Nature Park
- Jack's Ridge
- Japanese Tunnel

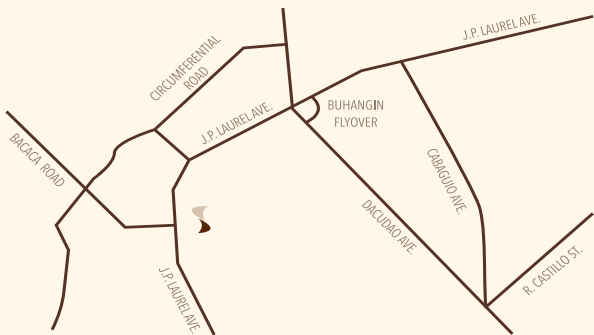

@sedahotels  
**SEDAHOTELS.COM**

T: (082) 322 8888  
F: (082) 322 8891  
E: dvo@sedahotels.com

J.P. Laurel Avenue  
Bajada, Davao City  
8000 Philippines





**Seda Abreeza offers a range of small to medium-size function venues for corporate presentations, trainings, meetings and private social celebrations. Located at the lobby and mezzanine levels, fully-equipped function rooms and efficient assistance from our Events Specialists ensure a smooth conduct of events from start to finish.**

**BOARDROOM** | An ideal venue for private meetings

**SINAMAY** | Versatile area that can be divided into three individual rooms or as one venue for up to 150 persons

**T'NALAK** | Flexible space that can be used as three separate rooms or as one big venue for up to 170 persons



Learn more about Seda Abreeza by scanning the QR code above

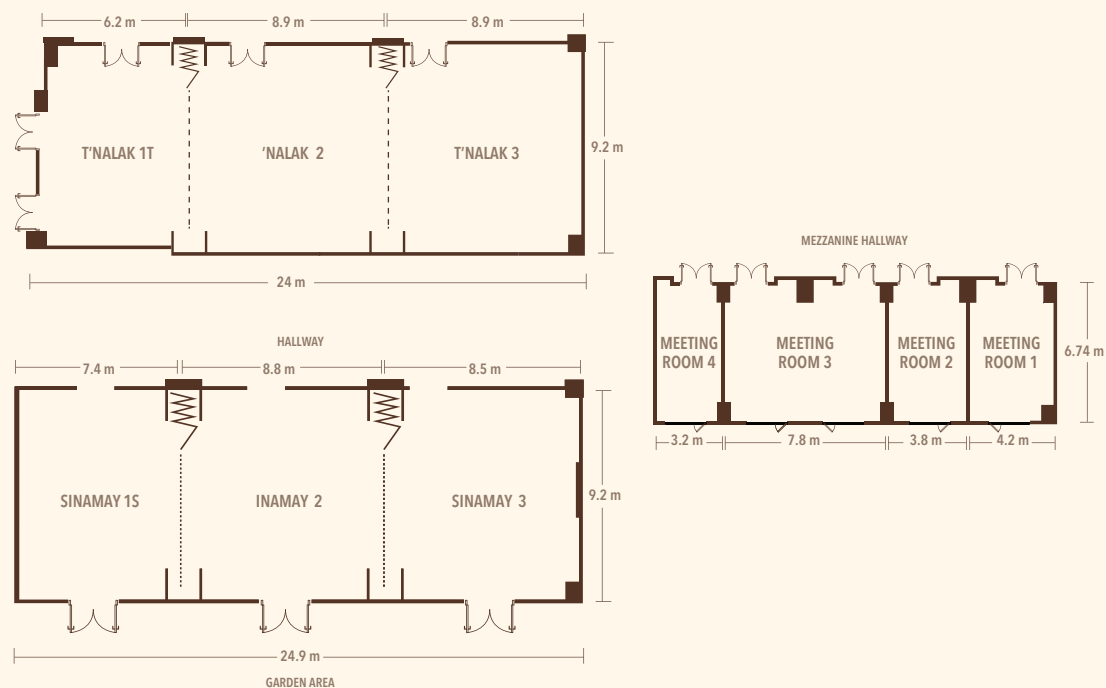

## DIMENSIONS

MEETING ROOM	L x W (METERS)	L x W (FEET)	FLOOR AREA (SQM)	CEILING HEIGHT (METERS)
Sinamay 1	9.2 x 7.4	30 x 24	68	4
Sinamay 2	9.2 x 8.8	30 x 28.8	81	4
Sinamay 3	9.2 x 8.5	30 x 27.8	78	4
Meeting Room 1	6.7 x 4.2	22 x 13.7	28	2
Meeting Room 2	6.7 x 3.8	22 x 12.4	25	2
Meeting Room 3	6.7 x 7.8	22 x 25.5	52	2
Meeting Room 4	6.7 x 3.2	22 x 10.4	21	2
T'nalak 1	9.2 x 6.2	30 x 20	57	4
T'nalak 2	9.2 x 8.9	30 x 29.1	82	4
T'nalak 3	9.2 x 8.9	30 x 29.1	82	4

## CAPACITIES

MEETING ROOM	COCKTAILS	ROUNDS	THEATER	CLASSROOM	BOARDROOM	U-SHAPE
Sinamay 1	25	20	30	24	20	21
Sinamay 2	32	40	50	36	27	24
Sinamay 3	32	40	50	30	27	30
Meeting Room 1	-	-	-	-	10	-
Meeting Room 2	-	-	-	-	10	-
Meeting Room 3	-	-	-	-	12	-
Meeting Room 4	-	-	-	-	10	-
T'nalak 1	30	30	30	24	20	21
T'nalak 2	32	40	50	36	27	30
T'nalak 3	32	40	50	36	27	24

## EQUIPMENT AND FACILITIES

- WiFi / Internet Access
- LCD Projector and Screen
- Stage, Dance floor, Riser, Podium
- Basic Sound System
- White Board / Flip Chart

## PACKAGES

- Conferences and Meetings
- Social Events

   
@sedahotels  
**SEDAHOTELS.COM**

T: (082) 322 8888  
F: (082) 322 8891  
E: dvo@sedahotels.com

J.P. Laurel Avenue  
Bajada, Davao City  
8000 Philippines





# #SafeAtSeda

## SAFETY & PREVENTION MEASURES

### GENERAL

- Comprehensive environmental sanitation and hourly disinfection of high-risk surfaces and touchpoints using EPA-registered / hospital-grade products
- High-temperature steamer for cleaning and deodorizing upholstery in guestrooms and meeting rooms, and of lobby and restaurant couches
- Temperature check and footwear sanitation prior to hotel entry
- Verification of vaccination card
- Wearing of face mask in public areas
- 70% alcohol-based hand sanitizer available in various areas of the hotel
- Physical distancing markers
- Signages about personal hygiene practices and general guidelines in highly-visible areas; with audio reminders in elevators
- Required spacing between tables and seats in dining outlets, meeting spaces, lobby, pool, and gym

### CHECK-IN

- Health Checklist & Travel Declaration form must be accomplished
- Online check-in encouraged
- Protective screen at the Front Desk counter between guests and staff

### BELL SERVICE

- Luggage disinfection upon arrival
- Luggage assistance only upon request
- Luggage brought up by bellmen are left outside the guestroom door

### MEETINGS & EVENTS

- Cocktail and buffet service are temporarily not available
- Food is plated or pre-packed in individual containers
- Desk pads and pens are provided only upon the guest's request

### RESTAURANTS

- Indoor dining is exclusively for fully-vaccinated guests; vaccination card must be presented prior to entry
- Tables and seats follow physical distancing regulations
- Menus in QR codes

### GUESTROOM

- Maximum number of room occupants corresponds to room size
- Switching/transferring of rooms is not allowed
- Reduction in room amenities like hair dryer, note pad and pen, throw pillows and bed runner (but available upon request)
- Temporary removal of mini-bar and reusable items
- Housekeeping service is provided only when the guest is not in the room

### IN-ROOM DINING

Orders will be individually-packed and left outside the guestroom door

### EMPLOYEES

- Thermal scanning is required prior to hotel entry
- Personal protection gear is worn at all times
- Continuous training in personal hygiene practices and strict adherence to safety and prevention measures
- Physical distancing in work stations and when interacting with guests

